



# ASENNUSOHJE / INSTALLATION GUIDE – Luna TWPC 26×140



Thermowood Plastic Composite (TWPC)



KOOLAUS / SUPPORT  
40 cm = 17 kpl/pcs/m<sup>2</sup>



140 mm  
26 mm

6,85 jm/m<sup>2</sup>  
6,85 rm/m<sup>2</sup>



Power drill

Varmista ruuvivääntimen sopiva momenttiasäätö, ettei kiristäminen vahingoita lautaa tai kiinnikettä. / When using a powered screwdriver please ensure the screws are not over tightened, as this may damage the board.



Plastic glue

RUOSTUMATON  
ROSTFREI  
STAINLESS  
INOXYDABLE  
ROSTFRI



4 – 4,2 × 35–45 mm  
← Ø max 8 mm

Screw



Rubber hammer

## 1 PERUSTA / SUPPORTING STRUCTURE

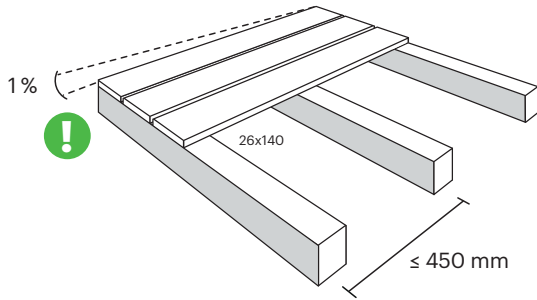

## 2 ALOITUS / TO START

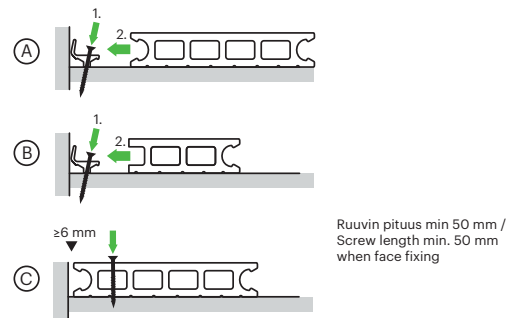

## 3 KIINNITYS / FASTENING

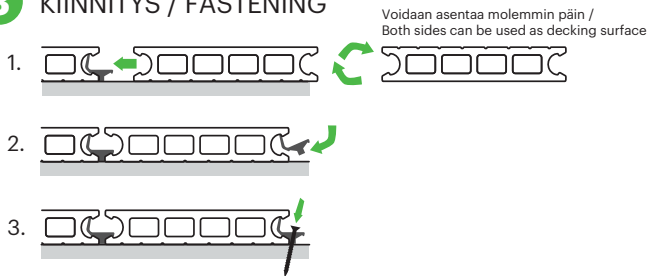

## 4 LAUDAN JATKAMINEN / END TO END JUNCTION

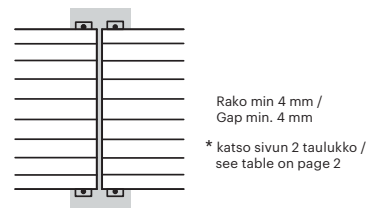

Kun asennat FastClip -piilokiinnikkeellä useampia komposiittiterassilautoja peräkkäin, on pituussuunnassa tapahtuva lämpölaajeneminen hyvä huomioida kiinnittämällä laudat yksittäisellä ruuvilla laudan keskikohdasta terassin runkoon. Tämä pakottaa terassilaudan pituuselämään mahdollisten suurten lämpötilavaihtelujen vuoksi tasaisesti. Kiinnitys runkoon voidaan tehdä laudan sivussa olevasta alasärmästä, jolloin ruuvien kanta ei jää näkyviin tai ruuvaamalla laudan keskeltä läpi.

When laying more than one board joined end to end, it is recommended to place a screw-fixing directly through the board, either through the face or hidden in the edge, at a halfway point along the length. This will ensure equal thermal expansion or contraction either side of the central fixing.

## 5 SIVUJEN VIIMEISTELY / FINALIZING BOARD EDGES

### ALUMIININEN KORISTELISTA / ALUMINIUM SIDE STRIP

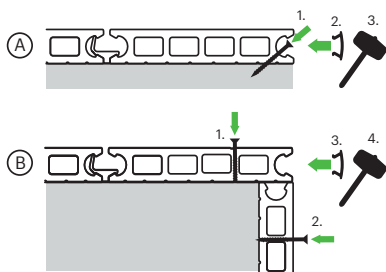

### ALUMIININEN L-LISTA (26×42 mm) / ALUMINIUM L-STRIP

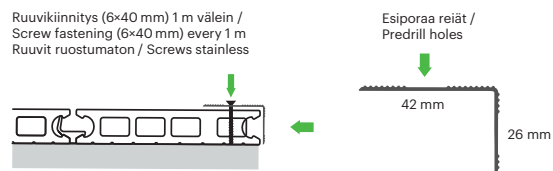

### ALUMIININEN KULMAKORISTELISTA / ALUMINIUM CORNER GUARD

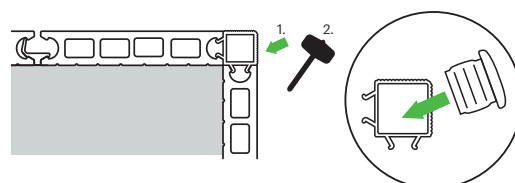

Päättytulppa kulmakoristelistaan / Plug for sealing corner guard

# ASENNUSOHJE / INSTALLATION GUIDE – Luna TWPC 26×140



Thermowood Plastic Composite (TWPC)



FastClip

KOOLAUS / SUPPORT  
40 cm = 17 kpl/pcs/m<sup>2</sup>



140 mm

26 mm

6,85 jm/m<sup>2</sup>  
6,85 rm/m<sup>2</sup>

---



Power drill

Varmista ruuvivääntimen sopiva momenttiasäätö, ettei kiristäminen vahingoita lautta tai kiinnikettä. / When using a powered screwdriver please ensure the screws are not over tightened, as this may damage the board.



Plastic glue

RUOSTUMATON  
ROSTFREI  
STAINLESS  
INOXYDABLE  
ROSTFRI



Screw

4 – 4,2 × 35–45 mm  
← Ø max 8 mm



Rubber-hammer

## 6 PÄÄTYJEN VIIMEISTELY / FINALIZING BOARD ENDS

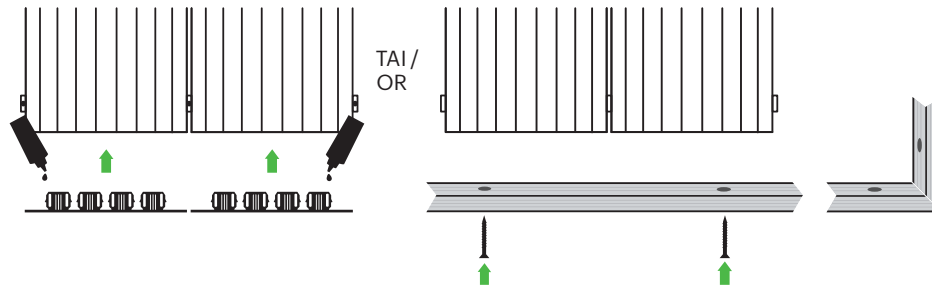

## 7 SAUMANAUHA / GAP STRIP (lisävaruste / optional)

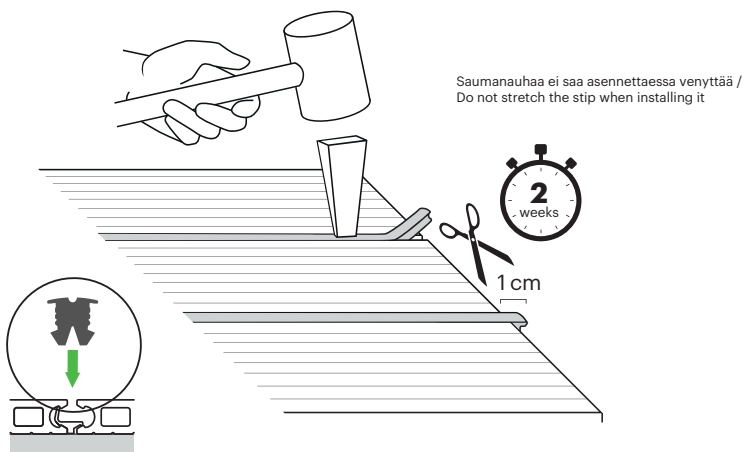

\* TWPC pituusmuutokset lämpötilan muuttuessa asennushetkestä / TWPC Thermal expansion and contraction in length due to changes in temperature

laajeneminen mm / supistuminen mm mm expansion / contraction				
muutos / change	1 m lauta / 1 m board	2 m lauta / 2 m board	3 m lauta / 3 m board	4 m lauta / 4 m board
10 °C	0,3 mm	0,6 mm	0,8 mm	1,1 mm
20 °C	0,6 mm	1,1 mm	1,7 mm	2,3 mm
30 °C	0,8 mm	1,7 mm	2,5 mm	3,4 mm
40 °C	1,1 mm	2,3 mm	3,4 mm	4,5 mm
50 °C	1,4 mm	2,8 mm	4,2 mm	5,6 mm